

THE PLAN SHOWING RESIDENTIAL LAYOUT IN THE NAME OF ROJA NAGAR AT R. S. NO: 125/2, 125/5, 125/6, 129/10 & 129/12 MANNADIPET REVENUE VILLAGE, VILLJANUR TALUK, MANNADIPET COMMUNE PANCHAYAT, THIRUKANUR (S.R), PUDUCHERRY.

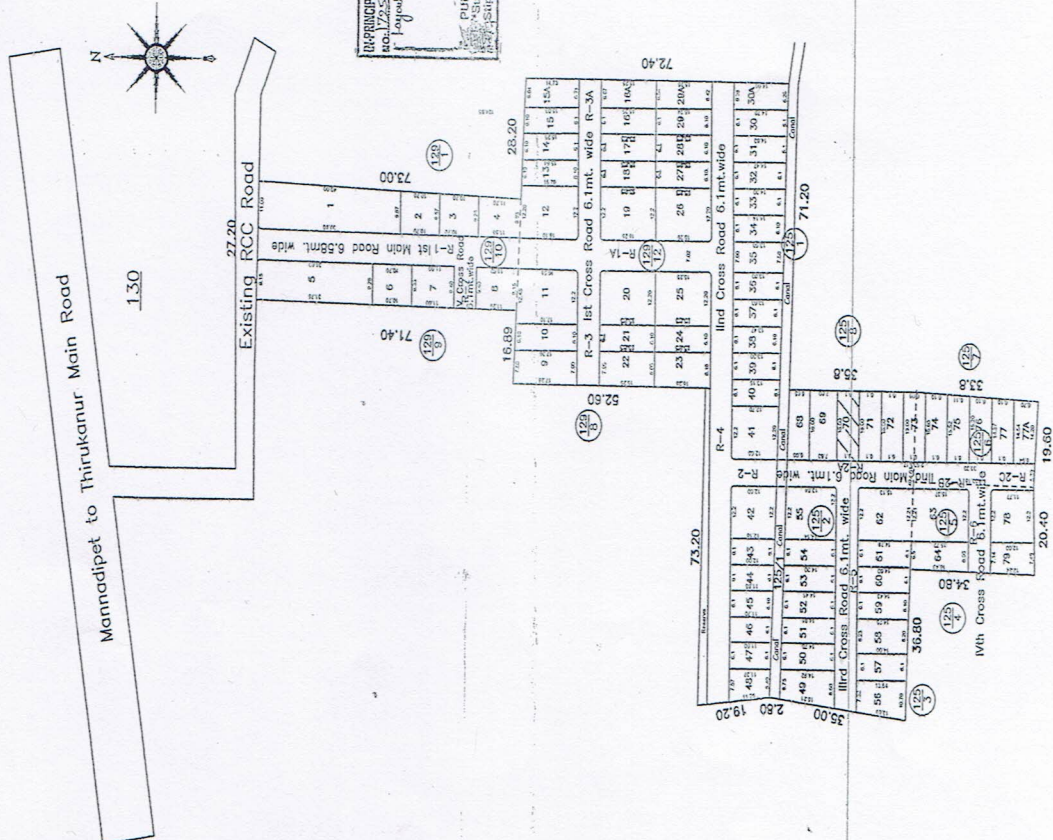

IN-PRINCIPLE LAYOUT FRAME WORK APPROVAL ISSUED W/RE NO. 125/125/2, 125/5, 125/6, 129/10 & 129/12 PUDUCHERRY PANCHAYAT, dated: 23 MAR 2012

MEMBER SECRETARY (U.S.)
PUDUCHERRY PLANNING AUTHORITY
Subject to the fulfilment of conditions and stipulations in the permit (Sl. No. 1 to 11) V

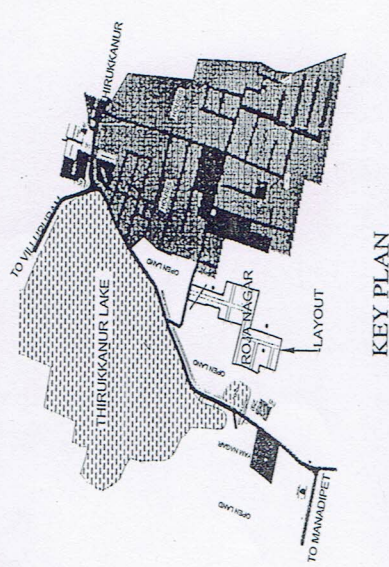

All Connections made by me
09/08/2012

Road name	Road No	Survey No	Sqm
I Main Road	R-1	129/10	468.00
	R-1A	129/12	347.10
II Main Road	R-2	129/12	6.40
	R-2A	125/5	24.11
	R-2B	125/5	36.62
	R-2C	125/6	159.28
I Cross Road	R-3	129/12	159.83
	R-3A	129/12	225.24
II Cross Road	R-4	129/12	869.49
III Cross Road	R-5	125/2	309.57
IV Cross Road	R-6	125/5	117.43
V Cross Road	R-7	129/10	57.54
Total			3057.43

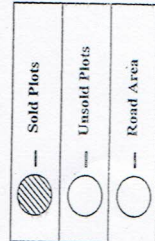

Unsold Plots			
Plot Number	Area (Sq.m)	Plot Number	Area (Sq.m)
1	405.59	27, 28 & 29	279.09
2	103.98	29A	98.88
3	100.70	30A	94.00
4	105.69	30	82.74
5	291.83	31	88.63
6	99.53	32	87.71
7	108.44	33	86.70
8	107.86	34	85.68
9	137.55	35	97.37
10	105.10	36	83.66
11	207.45	37	82.67
12	193.97	38	81.69
13	95.50	39	80.67
14	93.99	40	79.65
15	92.43	41	78.62
15A	100.70	42	150.52
16A	100.73	43	75.76
16	93.00	44	72.76
17 & 18	186.06	45	71.84
19 & 20	372.12	46	70.81
21	93.04	47	69.86
22	122.17	48	72.77
23	123.71	49	115.81
24	93.00	50	90.53
25 & 26	372.04	51	89.58
79			

Total Unsold Area : 9057.61 Sq.m
Sold Plot : 70
Total Sold Area : 97.67 sq.m
As Per Document : 12902 Sqmt
As Per Site : 12212.71 Sqmt

Owner's Signature
S. Rajamohan

Engineer's Signature
S. Rajamohan
PUDUCHERRY PANCHAYAT

Approving Authority