

**PROJECT TITLE**

PROPOSED RESIDENTIAL LAYOUT IN THE NAME OF "SRI CHINTALAMMAN NAGAR (45 PLOTS) AT R.S.NO.35/5B, THIRUBUVANAI & REVENUE VILLAGE, MANNADIPET COMMUNE, PUDUCHERRY

**LAYOUT DETAILS**

Total Layout Area	- 5320.00 Sq.m
Road Portion Area	- 849.51 Sq.m
Layout Area (Excluding Road)	- 4470.49 Sq.m
Regular Plot Area (35plots)	- 3973.37 Sq.m
EWS Plot Area (10 plots)	- 497.12 Sq.m
OSR Provided	- NIL
EWS Plot Area Required	- 447.05 Sq.m
OSR Required	- 194.95 Sq.m

**OWNER**

*V. Narayanamurthy*  
*Daitty*

**REGISTERED TOWN PLANNER / ARCHITECT**

*V. Narayanamurthy*  
 V. NARAYANAMURTHY, R.A.S. 04  
 REGISTERED ARCHITECT  
 CAR 215034  
 P.P.A. REG. NO. 1148/01/03/94

**SCALE : ( 1 : 500 )**  
 ALL DIMENSIONS ARE IN "METER"  
 (UNLESS OTHERWISE MENTIONED)  
 DRAWING SHEET NO -  
 TOTAL NUMBER OF SHEET -  NOS

**COLOUR INDEX**

- EWS PLOT
- REGULAR PLOT
- PROPOSED ROAD
- POND / CANAL
- BOUNDARY LINE
- EXISTING ROAD

*V. Narayanamurthy*  
*Daitty*

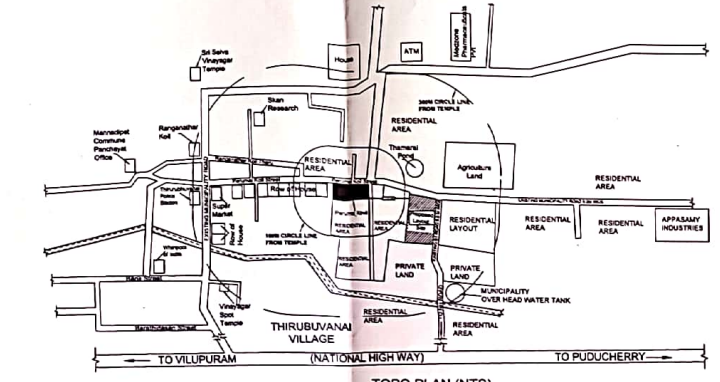

TOPO PLAN (NTS)

THE LAYOUT FALLS IN THE REGULATED AREA OF ASI TEMPLE. PERMISSION FOR CONSTRUCTION OF BUILDINGS WILL BE CONSIDERED ONLY AFTER RECEIPT OF CLEARANCE FROM THE DEPARTMENT OF ART & CULTURE, PUDUCHERRY.

Layout Plan Approved  
 No. PPA/RSO/3936/2/Layout/HCP/2020-2022

MEMBER SECRETARY  
 PUDUCHERRY PLANNING AUTHORITY

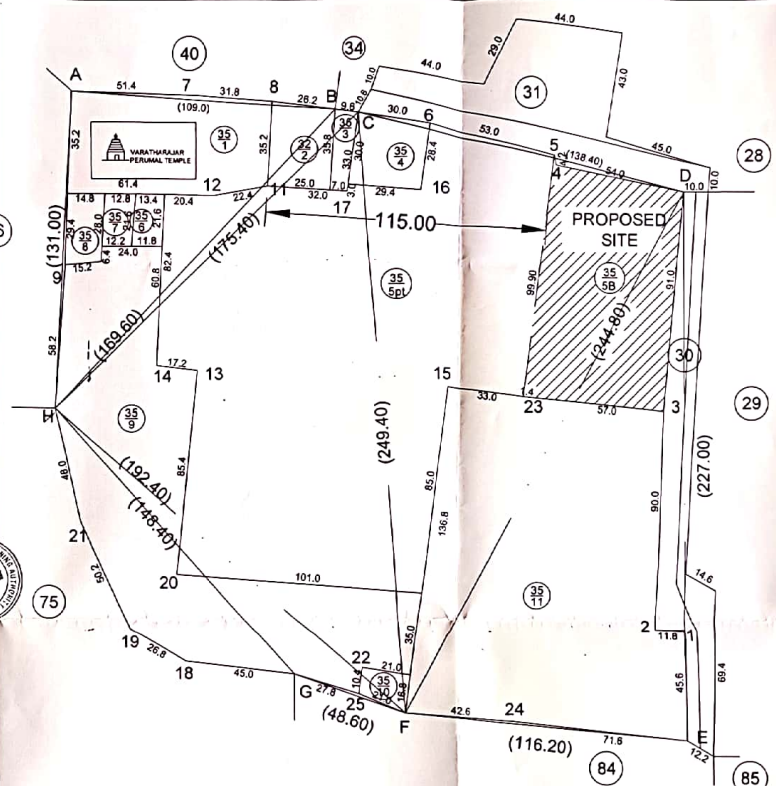

COMBINED FMB SKETCH FOR R.S. No. 35, 31, 30 SCALE (1:1000)

Sl. No	Plot No.	Extent Sq.m.	Sl. No	Plot No.	Extent Sq.ft.
1	1	139.17	19	19	111.63
2	2	100.60	20	20	111.63
3	3	100.58	21	21	111.63
4	4	100.17	22	22	111.63
5	5	100.04	23	23	111.63
6	6	103.70	24	24	111.63
7	7	107.20	25	25	109.53
8	8	120.40	26	26	133.66
9	9	133.60	27	27	160.58
10	10	111.63	28	28	111.63
11	11	111.63	29	29	111.63
12	12	111.63	30	30	111.63
13	13	111.63	31	31	111.63
14	14	111.63	32	32	111.63
15	15	111.63	33	33	111.63
16	16	111.63	34	34	111.63
17	17	110.51	35	35	110.51
18	18	110.51	36	Total	3973.37

RS.No	Patta No	Extent as per Document H.A. Ca	Sq.m.
35/5B	670	00.53.20	5320.00
TOTAL		00.53.20	5320.00

Sl. No	Plot No.	Extent Sq.m.	Sq.ft.
1	36	53.78	579
2	37	54.75	589
3	38	54.44	586
4	39	54.29	584
5	40	54.14	583
6	41	53.99	581
7	42	53.83	580
8	43	53.68	578
9	44	31.96	344
10	45	32.26	347
Total		497.12	5351

Name of the Road	Dimension (m)	Area (Sq.m)
Proposed Road - 1 <sup>st</sup> Cross	(1) 56.45 (avg) X 7.00	395.50
	(2) 9.00 X 2.00	18.00
	(3) 2 Splay	2.25
Proposed Road - 2 <sup>nd</sup> Cross	(1) 57.98 (avg) X 7.00	405.86
	(2) 9.30 X 2.00	18.60
Splay at top right corner	(3) 2 Splay	2.25
Area left along Perumal Kovil Street		4.48
Total		849.51

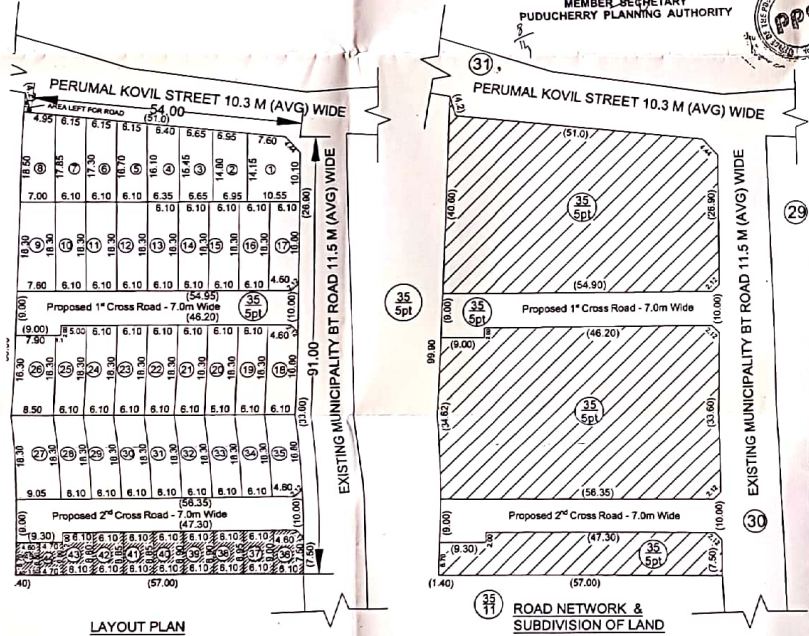

LAYOUT PLAN

ROAD NETWORK & SUBDIVISION OF LAND