

PLAN SHOWS THE "SRI MANAKULA VINAYAGAR NAGAR" RESIDENTIAL LAYOUT AT R.S.No.92/1,92/2,92/4,94/2,94/3,94/4, VILLIANUR REVENUE VILLAGE, VILLIANUR COMMUNE, PUDUCHERRY STATE.

17 MAY 2023
 Layout Plan Approved
 No. Proj/198 /110 /2/ Layout/17/2023
 MEMBER SECRETARY
 PUDUCHERRY PLANNING AUTHORITY

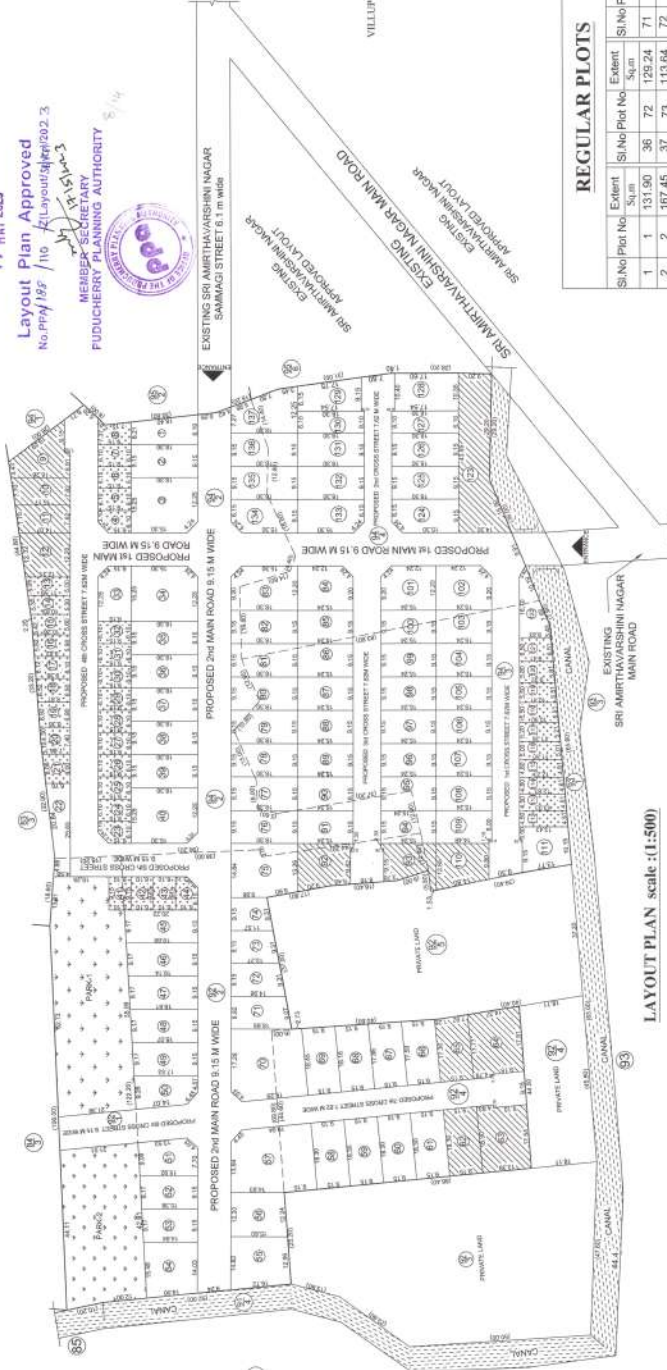
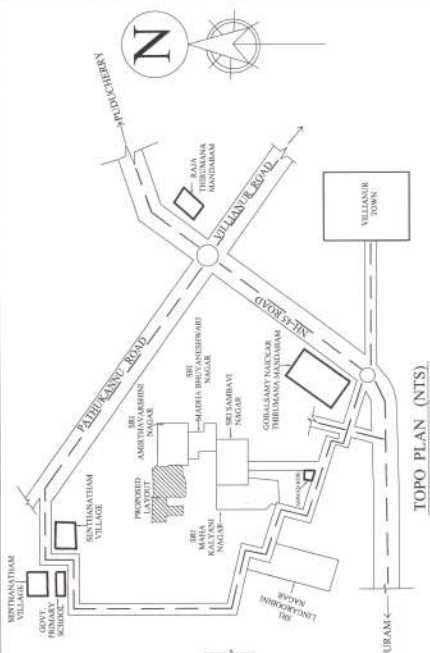

Description	Proposed Area (Sq.m)	Proposed %	Required Area (Sq.m)	Required %
Layout Area	28400.00	100.00%		
Road	7186.60	25.30%		
Excluding Roads	21213.40			
OSR	2261.60	10.66%	2121.34	10%
EWS Plots	2155.05	10.16%	2121.34	10%
Public Purpose Plots	2284.14	10.77%	2121.34	10%
Regular Plots	14512.61			

REGULAR PLOTS

Sl. No	Plot No.	Extent Sq.m	Sl. No	Plot No.	Extent Sq.m
1	1	131.90	36	72	128.24
2	2	167.45	37	73	113.64
3	3	274.60	38	74	98.10
4	4	134.60	39	75	264.60
5	5	335.04	40	76	167.45
6	6	274.60	41	77	167.45
7	7	35	42	78	167.45
8	8	167.45	43	79	167.45
9	9	167.45	44	80	167.45
10	10	167.45	45	81	167.45
11	11	167.45	46	82	167.45
12	12	274.58	47	83	218.80
13	13	182.54	48	84	181.43
14	14	177.60	49	85	139.45
15	15	172.71	50	86	139.45
16	16	167.81	51	87	139.45
17	17	162.87	52	88	139.45
18	18	140.89	53	89	139.45
19	19	153.81	54	90	139.45
20	20	143.20	55	91	139.45
21	21	138.26	56	94	139.45
22	22	162.77	57	95	139.45
23	23	222.85	58	96	139.45
24	24	184.71	59	97	139.45
25	25	405.40	60	98	139.45
26	26	167.45	61	99	139.45
27	27	167.45	62	100	139.45
28	28	167.45	63	101	181.43
29	29	167.45	64	102	181.43
30	30	158.62	65	103	139.45
31	31	162.28	66	104	139.45
32	32	164.90	67	105	139.45
33	33	167.50	68	106	139.45
34	34	389.29	69	107	139.45
35	35	141.07	70	108	139.45
TOTAL		14512.61			

PUBLIC PURPOSE PLOTS

Sl. No	Plot No.	Extent Sq.m
1	9	166.10
2	10	119.80
3	11	110.50
4	12	160.90
5	62	167.45
6	63	241.63
7	64	250.80
8	65	175.00
9	92	175.00
10	93	141.30
11	110	164.00
12	123	426.66
TOTAL		2284.14

EWS PLOTS

Sl. No	Plot No.	Extent Sq.m
1	4	51.32
2	5	55.81
3	6	55.81
4	7	55.81
5	8	54.50
6	13	59.80
7	14	59.41
8	15	58.80
9	16	59.24
10	17	58.90
11	18	59.25
12	19	59.44
13	20	59.60
14	21	57.44
15	23	51.32
16	24	59.81
17	25	58.81
18	26	59.81
19	27	59.81
20	28	59.81
21	29	59.81
22	30	59.81
TOTAL		2155.05

PARK AREA

Park No	Extent In Sq.m
PARK-I	1320.90
PARK-II	940.70
TOTAL	2261.60

ROAD AREA DETAILS

ROAD	Area In Sq.m
Proposed 1st Main Road (9.15 M)	1001.00
Proposed 2nd Main Road (9.15 M)	2215.40
Proposed 1st Cross Street (7.62 M)	579.20
Proposed 2nd Cross Street (7.62 M)	264.70
Proposed 3rd Cross Street (7.62 M)	600.20
Proposed 4th Cross Street (7.62 M)	889.20
Proposed 5th Cross Street (9.15 M)	294.70
Proposed 6th Cross Street (9.15 M)	538.50
Proposed 7th Cross Street (7.62 M)	538.50
Canal	455.20
TOTAL	7186.60

LAND AREA DETAILS

RS. No	Patta No	Extent In Sq.m
92/1	-	2650.00
92/2	-	5250.00
92/4	-	3000.00
94/2	-	7950.00
94/3	-	4950.00
94/4	-	4600.00
TOTAL		28400.00

OWNER
 A. Nair
 N. Jayant
 C. K. K. S.
 B. S. S. S.

REGISTERED ARCHITECT
 T. Aruna

LEGEND

- PUBLIC PURPOSE PLOTS
- EWS PLOTS
- PARK
- CHANNEL
- BOUNDARY LINE

REGULAR PLOTS = 87 Nos
 EWS PLOTS = 38 Nos
 PUBLIC PURPOSE PLOTS = 12 Nos
TOTAL = 137 Nos