

**PROPOSED RESIDENTIAL LAYOUT IN THE NAME OF " SELVA NAGAR " AT R. S. No. 168/5PT.,
PANGUR, ARIYUR REVENUE VILLAGE, VILLIANUR COMMUNE , PUDUCHERRY.**



13 JUL 2023

Layout Plan Approved

No.PPA/278/1599 /ELAYOUP/Sa-wj/2022-2023



MEMBER SECRETARY
PUDUCHERRY PLANNING AUTHORITY

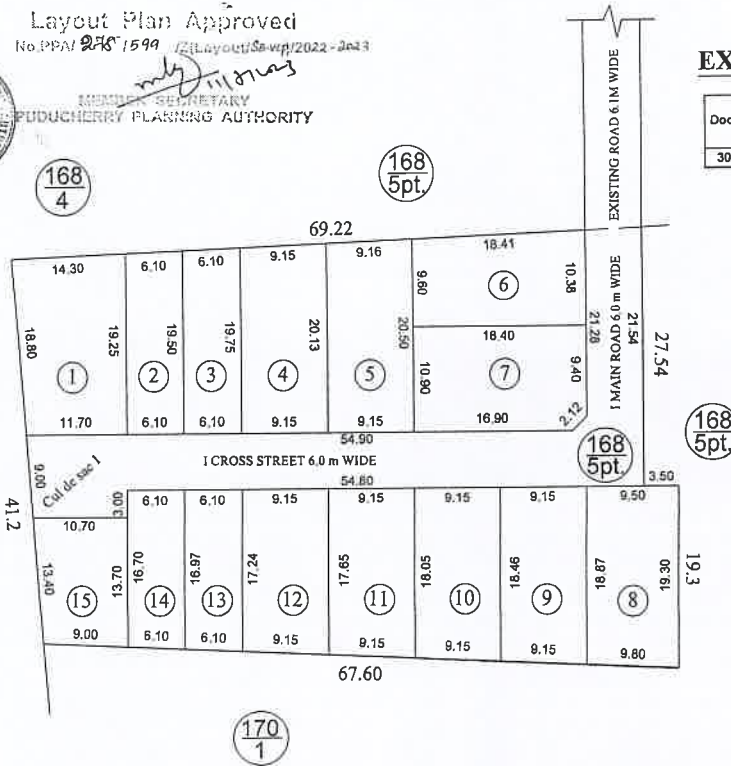

EXTENT DETAILS

Doc.No.	R.S.No.	EXTENT			
		H	A	Ca	Sq.m.
30795	168/5pt	0	30	66	3066

PLOT AREA DETAILS

Plot Number	Area (m ²)
1	247.33
2	118.19
3	119.71
4	182.45
5	185.98
6	183.87
7	199.43
8	184.17
9	170.78
10	167.03
11	163.33
12	159.62
13	104.34
14	102.69
15	133.47
Total	2422.39

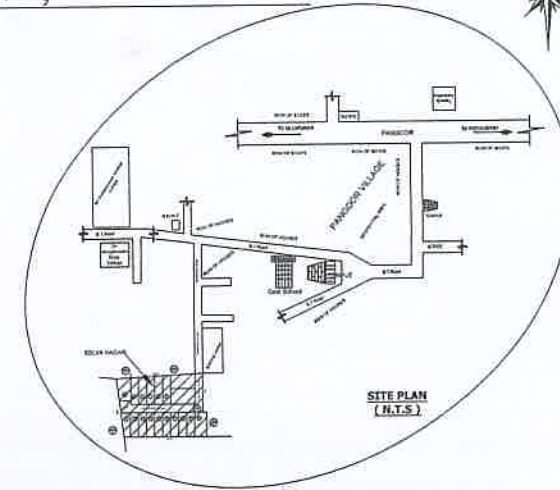

Area Details	Area (m ²)
TOTAL LAYOUT AREA	2981.88
PLOT AREA	2422.39
ROAD PORTION AREA	559.49

ROAD PORTION AREA

Road Name	Length (m)		Width (m)	Area (m ²)
	L1 (m)	L2 (m)		
Main Road	21.28	21.54	6.00	128.46
Cross Street	54.90	54.80	6.00	329.10
Corner Splay	1 No of (1.5 m X 1.5 m)			1.13
Cul de sac	10.70	11.70	9.00	100.80
Total				559.49

LAYOUT PLAN

(SCALE 1:500)

ALL DIMENSIONS ARE IN METER

LEGEND

SITE BOUNDARY	
PLOTS	
ROAD	
F- LINE	

J. Z. Singh

OWNER

J. Z. Singh

ARCHITECT