

**PLAN SHOWS THE RESIDENTIAL LAYOUT IN THE NAME OF " SRI VINAYAGA NAGAR" AT, R. S. No. 217/ 4pt., MANAPET, MANAPET REVENUE VILLAGE, BAHOUR COMMUNE , PUDUCHERRY.**

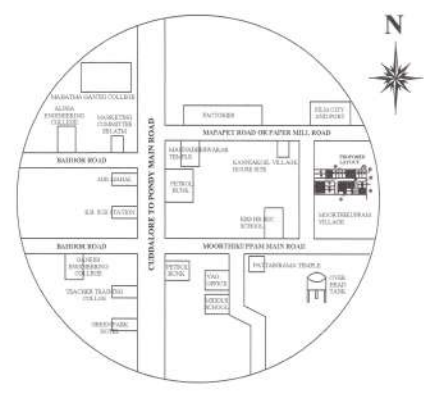
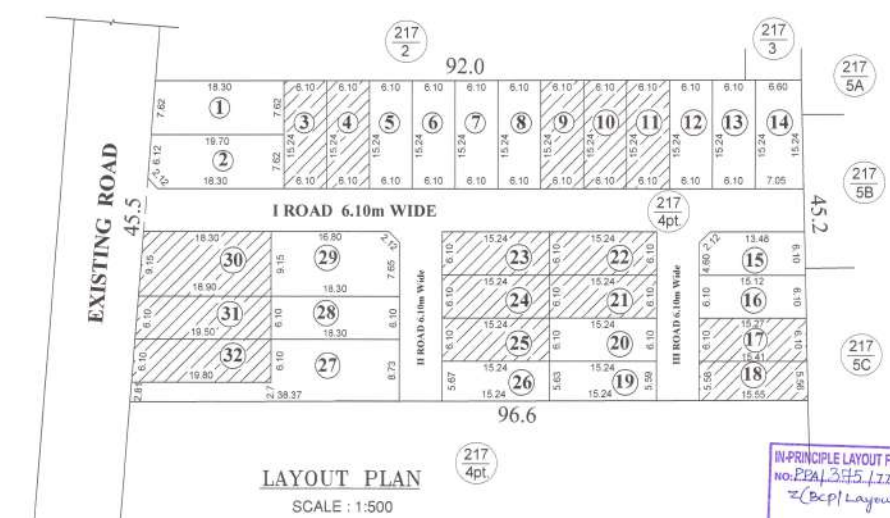

**IN-PRINCIPLE LAYOUT FRAME WORK APPROVAL ISSUED WIDE**  
NO. PPA/345/170-7/PPA/ DATED...  
2 (Bcp) Layout /IP-APPX 2019-23  
15/11/2019  
MEMBER SECRETARY  
PUDUCHERRY PLANNING AUTHORITY  
\*Subject to the fulfillment of conditions stipulated in the permit (Sl. No.1 to 8 )

Area Details	No. of Plots	Area (m <sup>2</sup> )
TOTAL LAYOUT AREA		4282.52
ROAD PORTION AREA		869.32
TOTAL PLOTS AREA	32	3413.2
SOLD PLOTS AREA	15	1516.29
UNSOLD PLOTS AREA	17	1896.91
OSR AREA PROVIDED		NIL
OSR REQUIRED (10%)		189.69

**UNSOLD PLOTS AREA**

Plot Number	No.	Area	Area (m <sup>2</sup> )
1	1	144.78	144.78
2	1	149.35	149.35
5 to 8	5	92.96	464.80
12 and 13	1	92.96	92.96
14	1	104.00	104.00
15	1	90.61	90.61
16	1	92.69	92.69
19	1	85.49	85.49
20	1	92.96	92.96
26	1	86.11	86.11
27	1	215.22	215.22
28	1	111.63	111.63
29	1	168.31	166.31
<b>Total</b>	<b>17</b>		<b>1896.91</b>

**SOLD PLOTS AREA**

Plot Number	No.	Area	Area (m <sup>2</sup> )
3 and 4	2	92.96	185.92
9 to 11	3	92.96	278.88
17	1	93.57	93.57
18	1	86.07	86.07
21 to 25	5	92.96	464.80
30	1	170.07	170.07
31	1	117.10	117.10
32	1	119.88	119.88
<b>Total</b>	<b>15</b>		<b>1516.29</b>

**ROAD PORTION AREA DETAILS**

Road Name	Length (m)		Width (m)	Area (m <sup>2</sup> )
	L1 (m)	L2 (m)		
I Road	93.95	94.24	6.10	573.98
II Road	23.98	23.97	6.10	146.25
III Road	23.89	23.88	6.10	145.70
Corner Splay (1.5m X 1.5m) - 3 Nos			1.13	3.39
<b>Total</b>				<b>869.32</b>

**EXTENT DETAILS**

R.S.No.	EXTENT			Area (m <sup>2</sup> )
	H	A	Ca	
217/4pt.	00	42	62.52	4282.52

**LEGEND**

- SITE BOUNDARY
- UNSOLD PLOTS
- SOLD PLOTS
- ROAD
- F-LINE

ALL DIMENSIONS ARE IN METER

A. K. J. G. G. G.  
R. Raoji

**OWNER**

*(Signature)*  
**Er. A. DAYANITHY**  
M. Tech. AEC. MICH  
Registered Structural Engineer Grade-II  
Reg. No. 3-333/PPA/LCO/SE/2016  
B-58, MG Flat,  
Sudhanthira Ponnudra Nagar,  
Puducherry - 11.

**ENGINEER**