

**THE PLAN SHOWING RESIDENTIAL LAYOUT IN THE NAME OF THILAI NAGAR AT R. S. NO: 101/24,
KODATHUR REVENUE VILLAGE, MANNADIPET COMMUNE PANCHAYAT, PUDUCHERRY.**

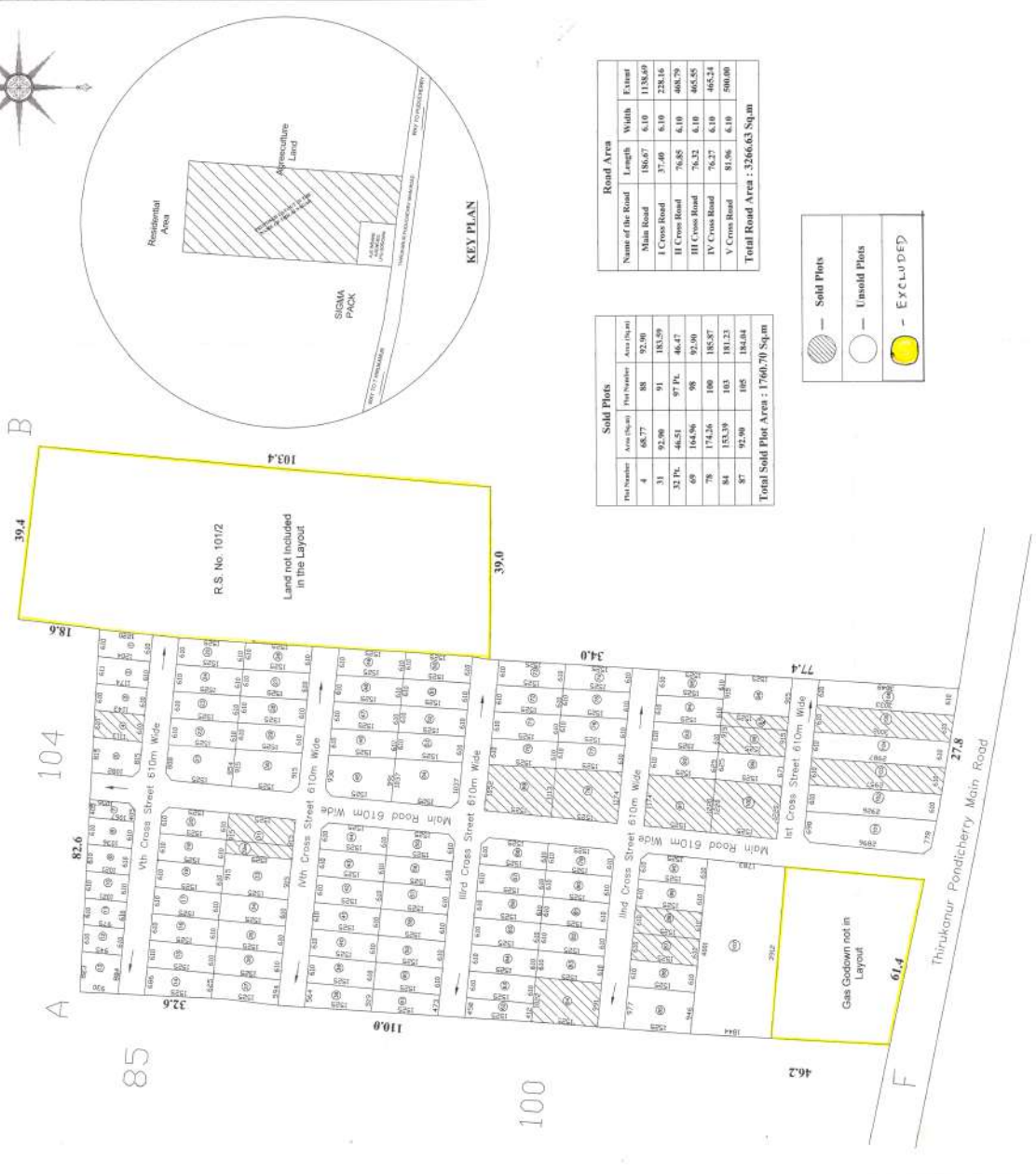

Total Land Area : 21158.36 Sq.m
Layout Area : 14592.36 Sq.m

AREA DETAILS

Total Sold Plot Area	1760.70 Sq.m
Total Unsold Plot Area	9549.28 Sq.m
Total Road Area	3266.63 Sq.m
Corner splay Area	15.75 Sq.m
O.S.R. Area	NIL
O.S.R. Required 10%	NIL

Unsold Plots

Plot Number	Area (Sq.m)	Plot Number	Area (Sq.m)	Plot Number	Area (Sq.m)
1	73.86	36	92.90	67	92.90
2	72.46	37	92.90	68	91.77
3	76.61	38	82.41	70	92.90
5	88.82	39	92.90	71	92.90
7	41.88	40	92.90	72	92.90
8	64.10	41	92.90	73	92.90
9	62.71	42	92.90	74	92.90
10	62.25	43	92.90	75	92.90
11	68.85	44	91.77	76	92.90
12	58.53	45	145.19	77	92.90
13	80.24	46	92.90	79	91.77
14	100.12	47	92.90	80	92.90
15	92.90	48	92.90	81	92.90
16	92.90	49	92.90	82	92.90
17	92.90	50	92.90	83	92.90
18	92.90	51	92.90	85	146.82
19	92.90	52	92.90	86	92.90
20	91.77	53	92.90	89	92.90
21	125.40	54	153.27	90	91.77
22	92.90	55	91.77	92	92.90
23	92.90	56	92.90	93	92.90
24	92.90	57	92.90	94	92.90
25	92.90	58	92.90	95	92.90
26	92.90	59	92.90	96	130.85
27	92.90	60	92.90	99	98.66
28	92.90	61	75.69	101	210.72
29	92.90	62	66.40	102	179.80
30	133.58	63	92.90	104	183.85
33	130.25	64	92.90	106	185.84
34	92.90	65	92.90	107	71.77
35	92.90	66	92.90		

Total Unsold Area : 9549.28 Sq.m

Road Area

Name of the Road	Length	Width	Extent
Main Road	186.67	6.10	1138.69
I Cross Road	37.40	6.10	228.16
II Cross Road	76.82	6.10	468.79
III Cross Road	76.82	6.10	468.58
IV Cross Road	76.27	6.10	465.24
V Cross Road	81.06	6.10	500.06

Total Road Area : 3266.63 Sq.m

Sold Plots

Plot Number	Area (Sq.m)	Plot Number	Area (Sq.m)
4	68.77	88	92.90
31	92.90	91	183.59
32 Pl.	46.51	97 Pl.	46.47
68	164.96	98	92.90
78	174.26	100	185.87
84	153.39	103	101.23
87	92.90	105	184.04

Total Sold Plot Area : 1760.70 Sq.m

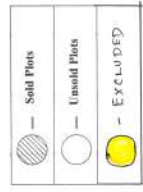

Owner's Signature: *[Signature]*

Engineer's Signature: *[Signature]*

E. M. Chandrasekaran
Registered Engineer
3781 PPA, LIC (RE) 2011
Puducherry

MEMBER SECRETARY
PUDUCHERRY MUNICIPAL CORPORATION
Registered in the permit (No. 1 to 11)

IN PRINCIPLE LAYOUT FRAME WORK APPROVED ISSUED DATE
NO. 272, LIC, PPA, LIC (RE) 2011, PUDUCHERRY, DATED: **24 SEP 2023**
1st Page (13 of 27) (24/9/23)

Approving Authority