

SOLD PLOTS		
SL. NO.	PLOT No.	AREA IN SQ.M
01	01	177.00
02	02	176.00
03	03	183.00
04	04	170.00
05	05	184.00
06	06	113.00
07	07	166.00
08	08	120.00
09	09	130.00
10	10	130.00
11	11	172.00
12	12	129.00
13	13	183.00
14	14	183.00
15	15	182.00
16	16	184.00
17	17	231.00
TOTAL		208.00

UNSAID PLOTS		
SL. NO.	PLOT No.	AREA IN SQ.M
01	01	113.00
02	02	185.00
03	03	18.82%
04	04	18.82%
05	05	18.82%
06	06	18.82%
07	07	18.82%
08	08	18.82%
09	09	18.82%
10	10	18.82%
11	11	18.82%
12	12	18.82%
13	13	18.82%
14	14	18.82%
15	15	18.82%
16	16	18.82%
17	17	18.82%
TOTAL		208.00

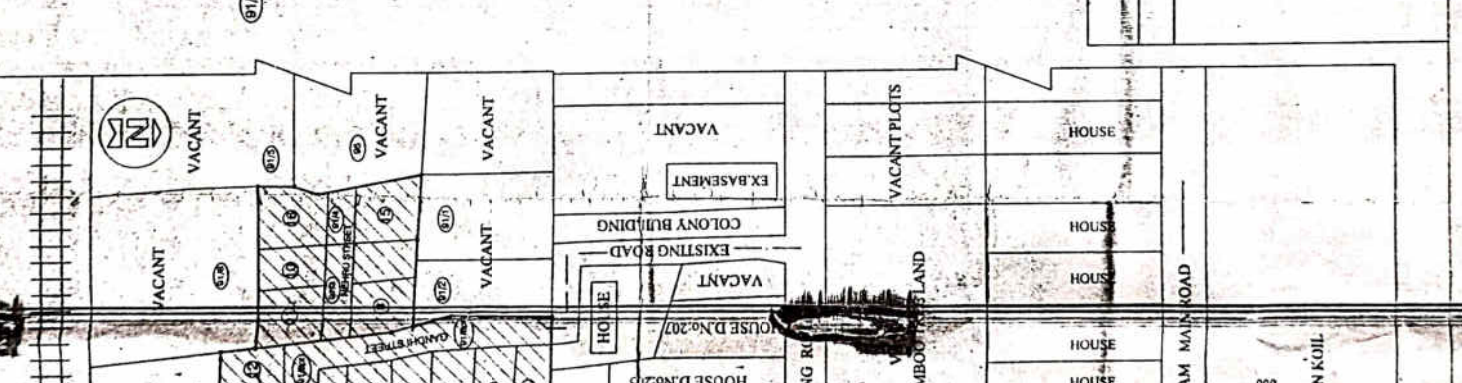
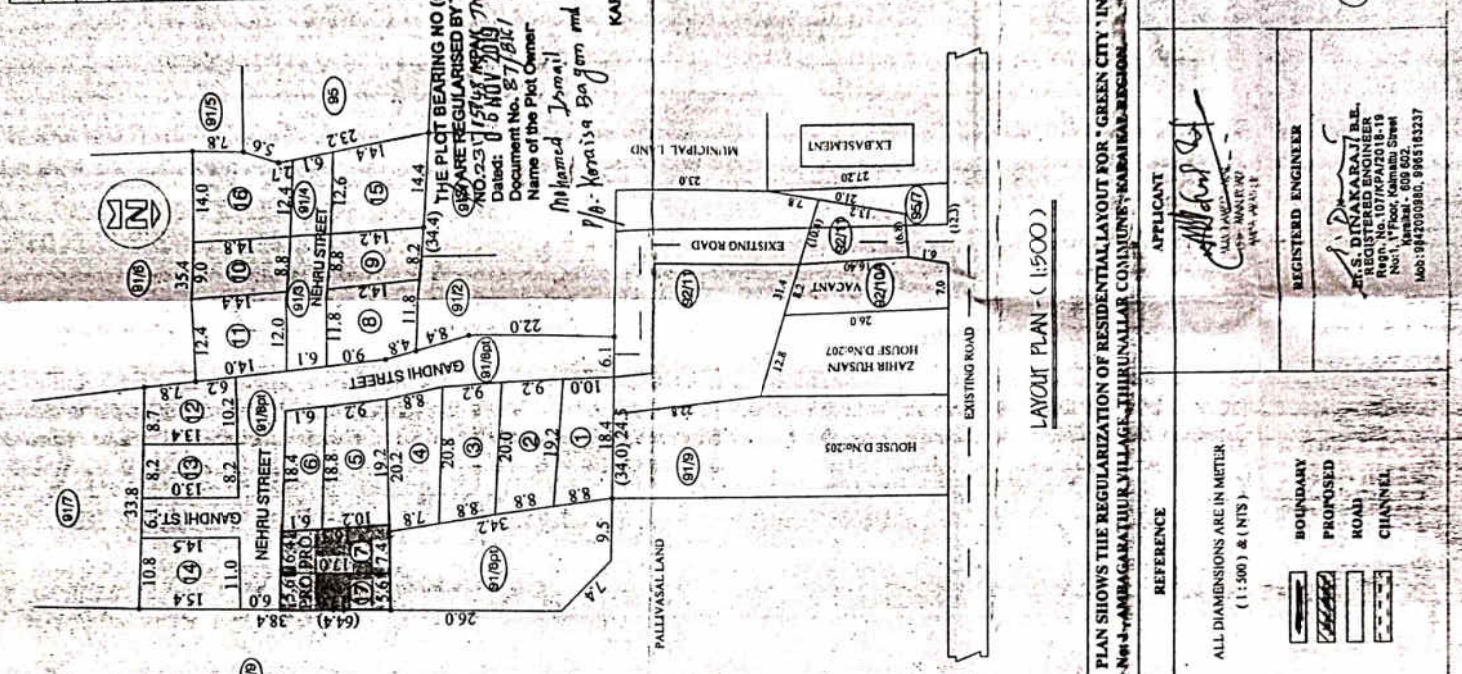

**PLAN SHOWS THE REGULARIZATION OF RESIDENTIAL LAYOUT FOR 'GREEN CITY' IN R.S.No: 91/3, 91/4, 91/8 PT., NO. 251, 15th MAIN ROAD, THIRUVALLAR COMMUNE - KARAikal REGION.**

**APPLICANT:** *[Signature]*  
**REGISTERED ENGINEER:** *[Signature]*  
**REG. NO.:** 107/P/PA/2018-19  
**Address:** No. 1, 1st Floor, Karaisa Street, Karaikal - 605 602.  
**Mobile:** 9842000860, 9965193237

**REFERENCE:** ALL DIMENSIONS ARE IN METER (1:500) & (NTS)

**BOUNDARY:** [Symbol]  
**PROPOSED:** [Symbol]  
**ROAD:** [Symbol]  
**CHANNEL:** [Symbol]

**KEY PLAN - NTS**

**THE PLOT BEARING NO (9) ARE REGULARISED BY THIS AUTHORITY AND LETTER NO. 251/15th MAIN ROAD, THIRUVALLAR COMMUNE - KARAikal REGION Dated: 08/11/2018**

**Name of the Plot Owner:** *[Name]*  
**Name of the Applicant:** *[Name]*  
**Name of the Member Secretary:** *[Name]*

**KARAIKAL PLANNING AUTHORITY**